

THE KOLKATA MUNICIPAL CORPORATION
 15/06/2018
 22/12/2018

All construction work shall be done in accordance with the Sanctioned Building Plan and the Corporation Building Plan. Any variation of the Building Plan may cause revocation of the Sanctioned Certificate.

SCHEDULE OF DOORS

MND	HALL	LVTBL	DOOR
D	-	2150	1800X2100
D1	-	2150	1100X2100
D2	-	2150	800X2100
D3	-	2150	750X2100
D4	250	2150	800X2100
DW1	-	2150	2400X2100
W	350	2150	2400X1800
W1	350	2150	2100X1800
W2	350	2150	900X1800
W3	1050	2150	1200X1100
W4	1050	2150	900X1100
W5	1250	2150	800X800
W6	350	2150	1200X1200
W7	350	2150	900X1200
W8	350	2150	1200X1800
BW1	350	2150	1800X1800
BW1'	350	2150	1800X1800
BW2	350	2150	1500X1800
BW2'	350	2150	1500X1800

DETAILS OF PLAN PROPOSAL

1. ASSESSEE NO. = 11-094-19-0040-9

2. DETAILS OF REG. DEED: 9/17-989970 2719 - 01782 - 2013
 A.D.S.R. ALPORE 24PARGANAH(S)
 9/19-489970 4232 - 04542 - 2012
 A.D.S.R. ALPORE 24PARGANAH(S)

3. DETAILS OF REG. P.O.A. - N.A.

4.a) LAND AREA = 625.29 SQ.M.
 (b) NO. OF STOREY = 10+1
 5. NO. OF TENAMENT = 12 NOS.
 6. SIZE OF TENAMENT (75 - 100) SQ.M. (100 - 200) SQ.M.
 = 05 NOS.
 = 07 NOS.

7. GROUND COVERAGE (48.94%) = 312.30 SQ.M.
 1. F.A.R. CONSUMED = 1.889
 2. F.A.R. COVERED AREA = 1.996/06 SQ.M.
 3. TOTAL SERVICE AREA IN GROUND (IN GR. FL.) = 229.45 SQ.M.
 4. NO. OF CAR PARKING - PROVIDED = 09 NOS.
 7. NO. OF CAR PARKING - PROVIDED GROUND COVERED = 09 NOS.



AREA STATEMENT :-

1. LAND AREA (AS PER U.L.R.) = 625.29 SQ.M.
 2. F.A.R. AVAILABLE = 2.00
 3. PERMISSIBLE GROUND COVERAGE (50.00%) = 312.645 SQ.M.
 4. CONSTRUCTED GROUND COVERAGE (48.94%) = 312.30 SQ.M.
 5. PERMISSIBLE BUILT-UP AREA (EXCL. EXEMPTED AREAS GIVEN BELOW) = 1250.86 SQ.M.
 6. CONSTRUCTED TOTAL BUILT-UP AREA (INCL. EXEMPTED AREAS GIVEN BELOW) = 1998.06 SQ.M.
 7. CONSTRUCTED AREAS:
 GROUND FLOOR = 232.30 SQ.M.
 1ST FLOOR = 285.19 SQ.M.
 TYPICAL FLOOR (308.85X3) (END. TO 4TH FL.) = 586.56 SQ.M.
 FIFTH FLOOR = 91.02 SQ.M.
 TOTAL = 1505.06 SQ.M.

8. TOTAL CAR PARKING ADVANTAGE TAKEN = 225.00 SQ.M.
 9. TOTAL AREA EXEMPTED FOR F.A.R. CALCULATION (a+b) = 125.00 SQ.M.
 a) STAIR WAYS AREA = 92.00 SQ.M.
 b) LIFT LOBBY @ 6 SQ.M. IN 5 FLS. = 33.00 SQ.M.
 10. TOTAL BUILT-UP AREA (EXCL. EXEMPTED AREAS BUT INCLUDING CAR PARKING AREA) = 1471.06 SQ.M.
 11. TOTAL CONSUMED F.A.R. 1471.06 - 225.00 = 1.993
 625.29
 12. TOTAL C.B. AREA = 18.78 SQ.M.
 13. W.C. AREA ON ROOF = 2.987 SQ.M.

DECLARATION OF OWNER

I DO HEREBY UNDERTAKE WITH FULL RESPONSIBILITY THAT I HAVE ENGAGED L.B.A. & ESE DURING CONSTRUCTION I HAVE FOLLOWED THE INSTRUCTION L.B.A. & ESE DURING CONSTRUCTION OF THE BUILDING (AS PER B.P. PLAN) BY K.M.C. AUTHORITY WILL NOT BE RESPONSIBLE FOR STRUCTURAL STABILITY OF THE BLDG. & ADJOINING STRUCTURE IF ANY SUBMITTED DOCUMENTS ARE FOUND TO BE FAKE. THE K.M.C. AUTHORITY WILL REVOKE THE SANCTION PLAN.

K90 PROP. DEAL. PVT. LTD.
T. K. Sanyal
 Director

SIGNATURE OF OWNER

CERTIFICATE OF STRUCTURAL STABILITY

WE HEREBY CERTIFY THAT THE ERECTION OF (G+10) STORED RESIDENTIAL BUILDING AT PREMISES NO. 17A, NAKULESHWAR BHATTACHARJEE LANE, KOLKATA - 25, WARD NO. 09A, BOROUGH - VIII, P.S. - TOLLYGUNGE, HAS BEEN SUPERVISED BY ME AND COMPLETED ON 20.09.2017 ACCORDING TO THE PLANS SANCTIONED U/S-389 VIDE B.P. NO. 2014080088 DATED 27.12.14 & FURTHER REGULARIZED U/S - 394 OF K.M.C. ACT 1980 VIDE B.P. NO. 2017080012, DATED 11.05.17 & SUBSEQUENTLY REGULARISED U/R-28 2(a) APPROVED BY O.S.D. (B) DATED 20.09.2017.

IT IS CERTIFIED THAT THE DEPTH OF SEMI UNDER GROUND WATER RESERVOIR HAS NOT BEEN EXCEEDED BEYOND THE DEPTH OF THE FOUNDATION AND THE SEMI UNDER GROUND & OVERHEAD WATER RESERVOIR HAS BEEN CONSTRUCTED AS PER SPECIFICATION AND IT IS SAFE AND STABLE IN ALL RESPECTS. ALSO THE STAIR CABIN & LIFT MACHINE ROOM HAS BEEN CONSTRUCTED AS PER SPECIFICATION AND IT IS SAFE AND STABLE IN ALL RESPECTS.

THE WORK HAS BEEN PARTLY COMPLETED AND IT IS TO MY SATISFACTION THE WORKMANSHIP AND ALL THE MATERIALS (TYPE/GRADE) HAVE BEEN USED STRICTLY IN ACCORDANCE WITH GENERAL AND DETAILED SPECIFICATIONS. NO PROVISION OF THE KOLKATA MUNICIPAL CORPORATION ACT 1980 AND THE KOLKATA MUNICIPAL CORPORATION BUILDING RULES OF 1980 HAVE BEEN VIOLATED IN COURSE OF THE WORK THE BUILDING IS FIT FOR WHICH IT HAS BEEN ERECTED.

Rupak Kumar Banerjee
RUPAK KUMAR BANERJEE
 B.C.E., M.E., MGS
 M.I.E. CHARTERED ENGINEER
 ENLISTED GEO. TECHNICAL ENGINEER (K.M.C.)
 G. TACKER, K.M.C.
 LM-4279, M-153878-5

SIGNATURE OF GEO. TECH. ENGR.

S. J. Parekh
SANJIV J. PAREKH
 M.E. (STRUCT.) B.A.E., PGCCM,
 C. (ENG.) - I, MSCE, ASCE, FIE (F-018202-9)
 F.S.E. No. 104 (I) K.M.C.

SIGNATURE OF STRUCTURAL ENGR.

JAY PRAKASH BHARAT KUMAR AGRAWAL
 B. Arch., A.I.I.T.A.
 Reg. No. GA/88/10098
 ARCHITECT SL. NO. - 32(A)

SIGNATURE OF ARCHITECT.

TITLE: GROUND FLOOR PLAN, PLAN & SECTION OF U.G.W.R., SITE PLAN & LOCATION PLAN

PROJECT: COMPLETION PLAN OF (G+10) STORED RESIDENTIAL BUILDING AT PREMISES NO. 17A, NAKULESHWAR BHATTACHARJEE LANE, KOLKATA - 25, WARD NO. 09A, BOROUGH - VIII, P.S. - TOLLYGUNGE, SANCTIONED U/S-389 VIDE B.P. NO. 2014080088 DATED 27.12.14 & FURTHER REGULARIZED U/S - 394 OF K.M.C. ACT 1980 VIDE B.P. NO. 2017080012, DATED 11.05.17 & SUBSEQUENTLY REGULARISED U/R-28 2(a) APPROVED BY O.S.D. (B) DATED 20.09.2017

ARCHITECTS

AGRAWAL & AGRAWAL	BARODA	KOLKATA	DEALT	CHECKED
SCALE	DATE	22.03.18	SUPRIYA	
1:100				

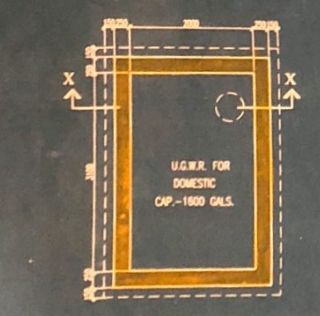
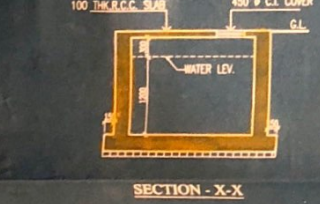
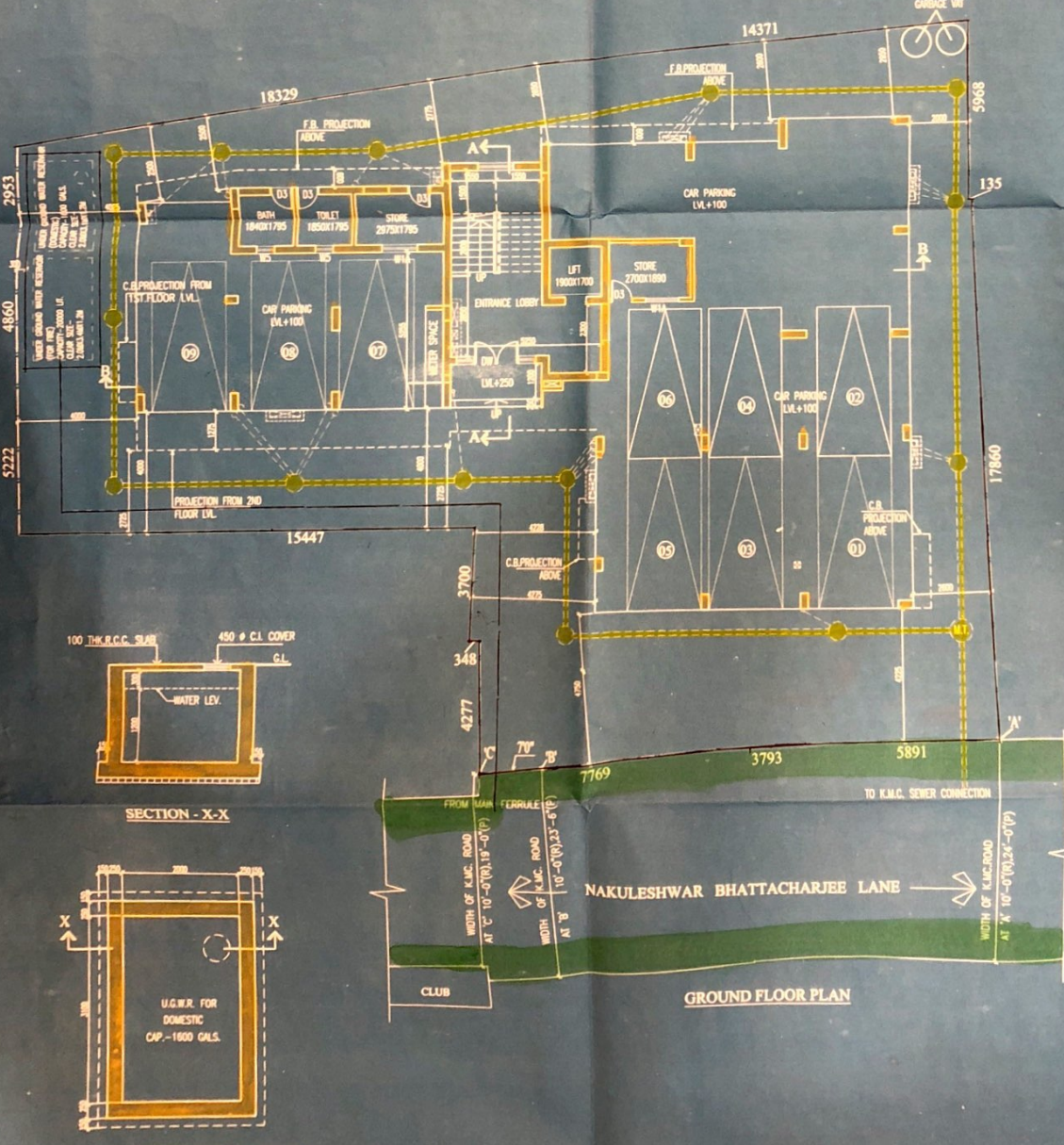

PLAN OF U.G. WATER RESERVOIR
 CAPACITY - 1600 GALS.
 SCALE - 1:50

PARTY'S COPY

Full Completion
Certificate U/R. 28.....
of K. M. C. Building rules

2009.....approved by
D. 2009.....dt. 11/06/2018

THE KOLKATA MUNICIPAL CORPORATION
BUILDING DEPT.
COMPLETION PLANS
Dated... 15/06/2018.....
Building Permit No. 2014080088.
Date... 27/12/2014.....
Borough No. M-1.....Ward No. 84.....
Mogemdas.....
A. E. (C) Br. No. VIII E. E. (C) B No. VIII

Any unauthorised construction done
in deviation from the Sanction Building
permit and the Completion Plans
after issuance of this Completion
Plans may cause revocation of the
Occupancy Certificate.



2. PRECAUTIONS TO BE TAKEN FOR POLLUTION FREE ENVIRONMENT.

20. Construction in buildings with generator fabric installing dust barriers, or other means, as appropriate for the location.
21. Apply water and mop up with a rubber dolly or similar machine for temporary stabilisation.
22. Avoid water spray by watering or any other work involving activity to keep the soil moist throughout the process.
23. Earth walls to be sprayed to 15 m/s on the work site.
24. Place of work and all the surface of road right prior to starting construction site.
25. Any A, and machine and equipment on the site.
26. Apply a cover or screen to stockpiles and rubbish stockpiles if (disruption of activity by water and moisture) shall stabilize in all water surfaces of the stockpiles.
27. Stabilize surface work where workers in open equipment and vehicles will operate by using water and moisture surface work in a stabilized condition where workers support equipment and vehicles will operate.
28. Stabilize adjacent open areas with following paving activities with immediate landscaping activity or installation of large trees or rock cover.
29. Minimize dust during working hours and clean tracks out from paved surfaces at the end of the work shift/day. Tracks that must have covered 50 feet or more and must be cleaned daily, at the minimum.
30. Stabilize working surfaces using soil binders until vegetation or ground cover can effectively stabilize the area.
31. Coordinate all debris in consultation with the local authority following proper environmental management practice.
32. During construction work, including cutting of mounds, avoid water level should not exceed more than 0.5m.

3. Practices to be observed for pollution free Environment.

33. Don't dispose of debris indiscriminately.
34. Don't allow the vehicles to run at high speed within the work site.
35. Don't use materials without proper dust control/cover on-out facility.
36. Don't leave materials without effective cover.
37. Don't allow access to the work area except workers in hard hat distribution and permit access by workers, officials, suppliers, items or other utility service.
38. Don't use the back, hand and shovel work uncovered.
39. Don't bring materials, debris on the roads or pavements.
40. Tackling of mud areas to be the paved as a final during construction and repair of the roads by mowing and for disposal.

OFFICE OF THE EX-ENGINEER (CIVIL)
BUILDING DEPARTMENT
BOROUGH-VIII
THE KOLKATA MUNICIPAL CORPORATION
104, RASHI BEHARI AVENUE
KOLKATA-700 029